

SG2/D-60 Damping Stopper Set  
Instruction & Maintenance Manual  
SG2/D-60 缓冲挡停器安装使用维护手册

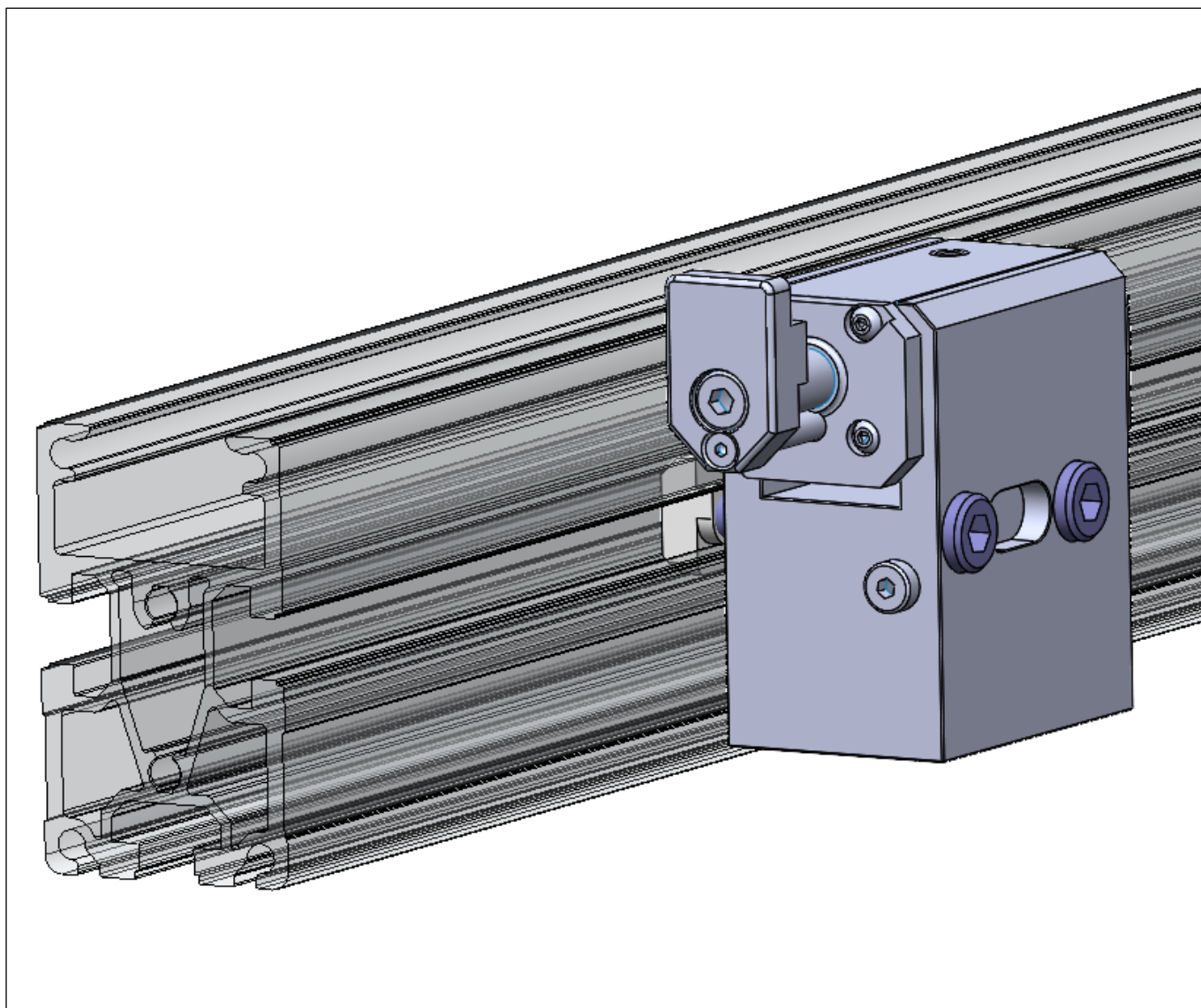

Suzhou LinkedGo Transfer System Co.,Ltd.

苏州领科工业技术有限公司

Structure Diagram 结构示意图

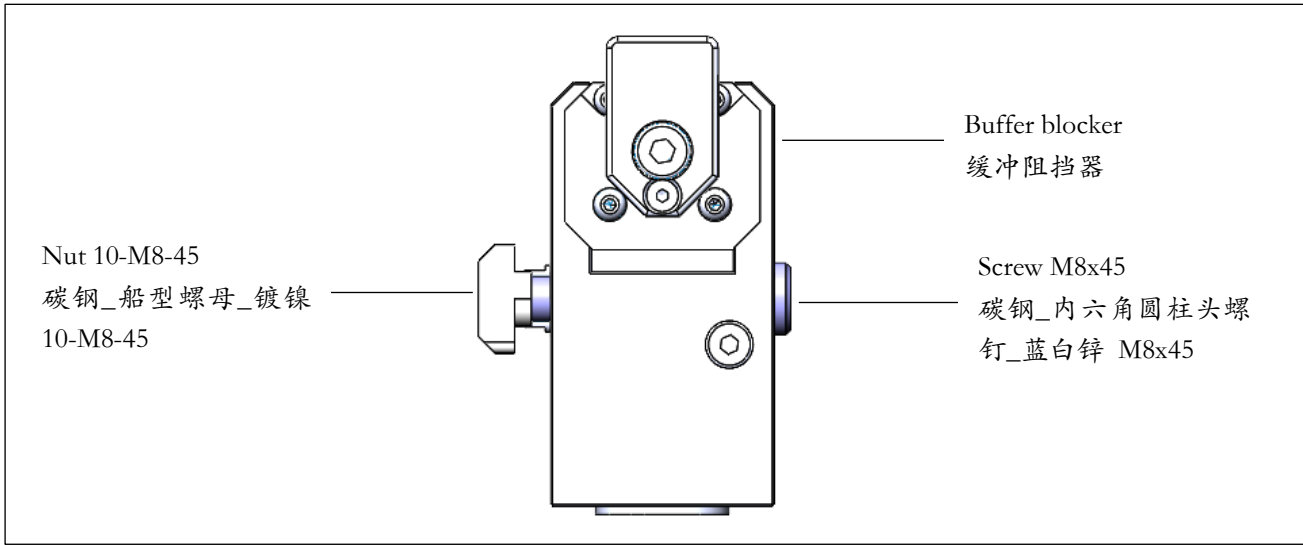

- 1、 The pneumatic buffer stop device can achieve a smooth buffering stop and release of the tray to the predetermined position on the conveying system, avoiding the tray from rebounding due to rigid collision.
- 1、 气动缓冲挡停器可以实现输送系统上托盘平稳缓冲停止和放行到预定位置，避免托盘受到刚性碰撞而产生反弹。
- 2、 Blocker load capacity: 60kg (at a transmission speed of 6m/min).
- 2、 阻挡器负载能力： 60kg（传输速度 6m/min 时）。
- 3、 Buffer stroke: 18mm.
- 3、 缓冲行程： 18mm。
- 4、 Blocking block descent stroke: 8mm.
- 4、 阻挡块下降行程： 8mm。
- 5、 Tracheal interface:  $\Phi$  6mm.
- 5、 气管接口：  $\Phi$ 6mm。
- 6、 Working pressure: 4-8 bar compressed air.
- 6、 工作压力： 4-8 bar 压缩空气。
- 7、 Shock absorption can be infinitely adjusted.
- 7、 减震可无极调节。

产  
品  
特  
征

安  
装  
步  
骤

维  
护  
保  
养

安装步骤 Installation steps

A Install the stopper onto the wire body as shown in the following diagram.

A 按下图所示，将阻挡器安装到线体上。

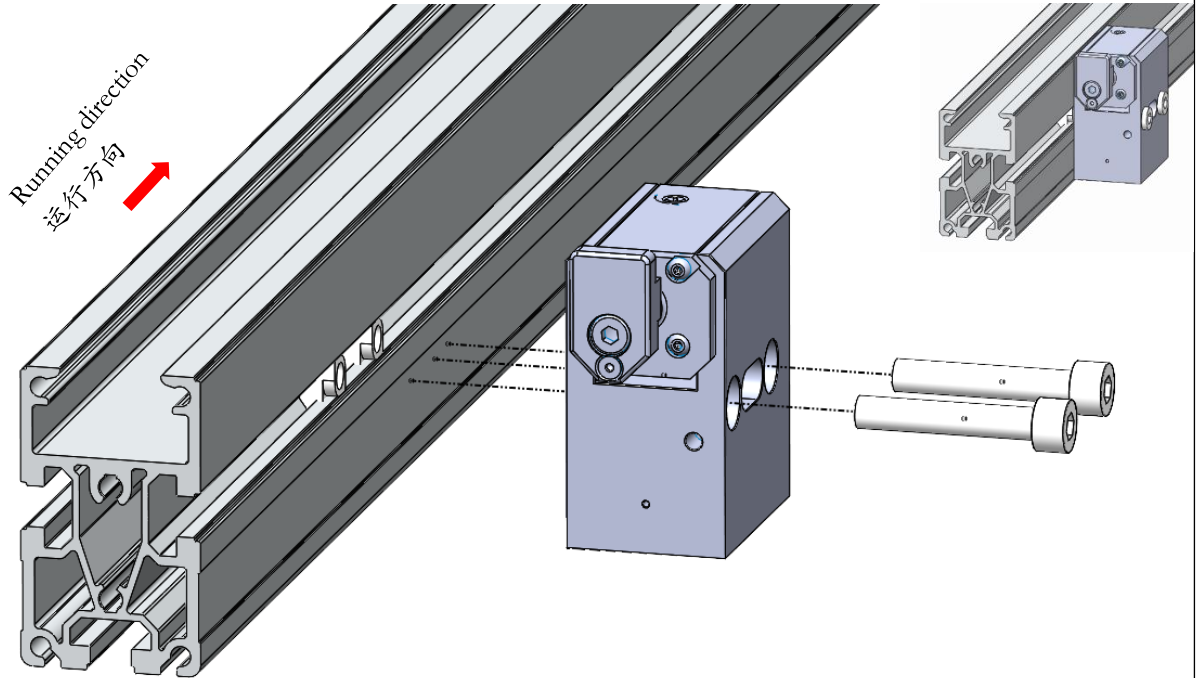

Stop one or more stacked workpiece trays at the designated position. When the pressure is released, the spring closes the stopper, thereby stopping the workpiece tray. Directly installed on the conveyor section within the track.

将一个或多个堆积的工件托盘挡停在指定的位置上。当压力释放时，弹簧将挡停器关闭，从而挡停工件托盘。在轨道之内直接安装在输送段上。

B Buffering regulation.

B 缓冲调节。

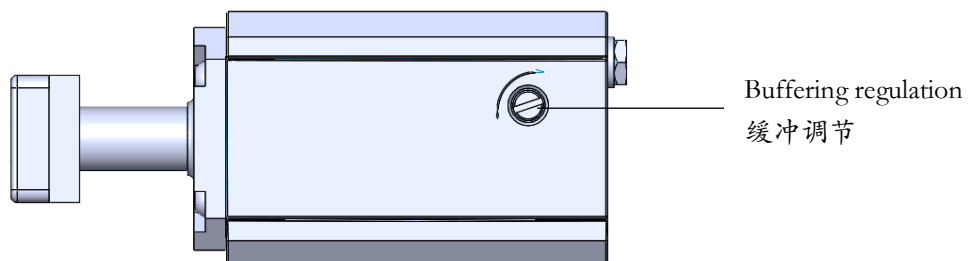

产品特征

安装步骤

维护保养

Maintenance 维护和保养

The UTS series tray conveying system requires regular maintenance and upkeep to extend the service life of the line. The conveying equipment should be kept clean to avoid direct sunlight or rain or snow, and to prevent contact with substances such as acids, alkalis, oils, organic solvents, etc.  
UTS 系列托盘输送系统需按周期进行规定的保养维护工作，以延长线体使用寿命。输送设备应保持清洁避免阳光直射或雨雪浸淋，防止与酸、碱、油类、有机溶剂等物质接触。维护前需关闭对应的能源供给。

Disclaimer  
免责声明  
The customer shall inspect the equipment regularly. If the customer fails to maintain the conveyor as the state above, leading to any malfunction or damage to the conveyor, our company will not be responsible for it, all related costs (including material costs, installation and commissioning fees, and hotel expense) shall be borne by the customer.  
客户应定期对设备进行检查。若客户未按要求对输送机进行维护，进而导致输送机发生任何故障或损坏，我司将不承担相关责任，由此产生的相关费用（材料费，安装调试费，差旅费）均由客户承担。

产  
品  
特  
征

安  
装  
步  
骤

维  
护  
保  
养

Suzhou LinkedGo Transfer System Co.,Ltd.  
苏州领科工业技术有限公司

[Tel: +86-512-6636 1885](tel:+86-512-66361885)

Add: Room 706, Building D, Dongchuang Science and Technology Park, No.  
216 Jinfeng Road, Wuzhong District, Suzhou, P.R. China

Zip code:215101

E-mail: [Sales@LinkedGo.com.cn](mailto:Sales@LinkedGo.com.cn)

Website: [www.LinkedList.com.cn](http://www.LinkedList.com.cn)

Subject to technical modifications

电话: +86-512-6636 1885

地址: 苏州市吴中区木渎镇金枫路 216 号东创科技园 D 幢 706 室

邮编: 215101

邮箱: [Sales@LinkedGo.com.cn](mailto:Sales@LinkedGo.com.cn)

网址: [www.LinkedList.com.cn](http://www.LinkedList.com.cn)

我司保留技术更改的权利